

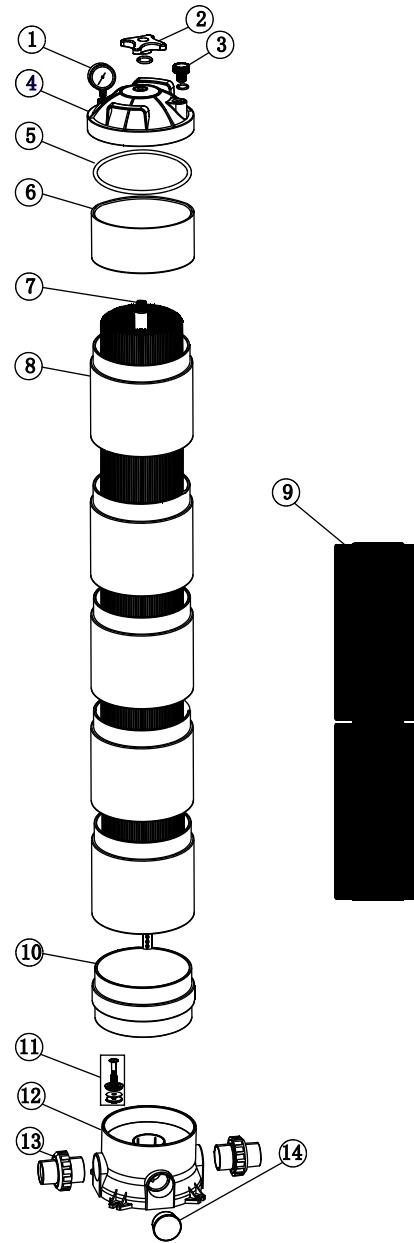

quimiac**pool**
Expertos en albercas

REPLACEMENT PARTS OF MULTIPORT VALVE

Item	Part No.	Description	Qty
1	06011021	Oil Pressure Gauge With O-ring (50 psi)	1
	01111048	Connector for Pressure Gauge/Stopper	1
2	89060201	Star-Shaped Nut With O-Ring	1
3	89060102	Air Release Valve	1
4	01011021	Cartridge filter Lid	1
5	02011150	O-Ring for Lid	1
6	01011003	Upper part of cartridge filter	1
7	89060202	CFO25 Air Vent Pipe	1
	89060203	CFO50 Air Vent Pipe	1
	89060204	CFO75 Air Vent Pipe	1
	89060205	CFO100 Air Vent Pipe	1
	89060206	CFO150 Air Vent Pipe	1
	89060207	CFO200 Air Vent Pipe	1
8	01011004	CFO50 Upper Tank Body	1
		CFO75 Upper Tank Body	2
		CFO100 Upper Tank Body	3
		CFO150 Upper Tank Body	4
		CFO200 Upper Tank Body	5
9	88270101	CFO25 Element	1
	88270102	CFO50 Element	1
	88270103	CFO75 Element	1
	88270104	CFO100 Element	1
	88270105	CFO150 Element	1
	88270106	CFO200 Element	2
10	01011005	Body Support	1
11	89060109	Pressure Release Valve	1
12	01011022	Base for CFO Series Cartridge Filter	1
13	89060110	1.5"Union for Cartridge filters (Imperial)	2
	89060111	1.5"Union for Cartridge filters (Metric)	2
	89060112	2.0"Union for Cartridge filters (Imperial)	2
	89060113	2.0"Union for Cartridge filters (Metric)	2
14	01011015	Plug	1



WARNING

- ⚠ THIS FILTER OPERATES UNDER HIGH PRESSURE. WHEN ANY PART OF THE CIRCULATING SYSTEM (e.g., CLAMP, PUMP, FILTER, VALVES, ETC.) IS SERVICED, AIR CAN ENTER THE SYSTEM AND BECOME PRESSURIZED. PRESSURIZED AIR CAN CAUSE THE LID OR VALVE TO BE BLOWN OFF WHICH CAN RESULT IN SEVERE INJURY, DEATH, OR PROPERTY DAMAGE
- ⚠ TURN PUMP OFF BEFORE CHANGING VALVE POSITION.
- ⚠ TO PREVENT DAMAGE TO THE PUMP AND FOR PROPER OPERATION OF THE SYSTEM, CLEAN PUMP STRAINER AND SKIMMER BASKETS REGULARLY.
- ⚠ DO NOT UNSCREW SCREWS OF FLANGE CLAMP WHILE PUMP IS RUNNING.

CARTRIDGE FILTER

Models: CFO25, CFO50, CFO75, CFO100
CFO150, CFO200

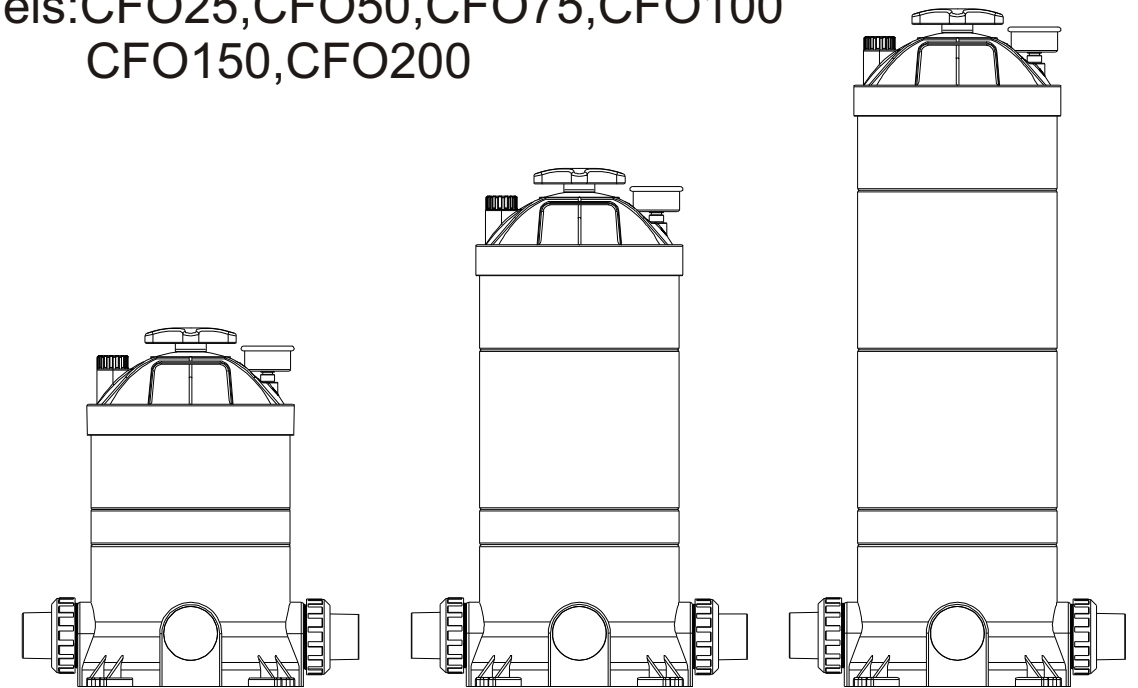

The installation of this product should be carried out by a person knowledgeable in swimming pool plumbing requirements, following the installation instructions provided in this manual. please pass these instructions on to the owner of this equipment.

YOUR EMAUX CARTRIDGE FILTER

Congratulations on your purchase of a quality product from the range of pool and spa Equipment available from EMAUX Pool Systems. You are assured of many years of reliable and efficient performance from your EMAUX filter backed by a 2-year tank warranty.

EMAUX cartridge filters have been specifically designed for the filtration of spa and swimming pool water. They should not be used for any other purpose without first consulting your EMAUX dealer or EMAUX pool systems.

EMAUX cartridge filters provide economy, high performance and convenience in a well-designed pressure filter. The polyester element can be removed quickly for rinse cleaning without water loss. EMAUX cartridge filters feature large filter areas, which ensure even water distribution, peak filtration performance and longer filter cycles.

The corrosion-resistant construction of EMAUX cartridge filters provides long life and durability. EMAUX cartridge filters are capacity matched with the EMAUX range of pool and spa pumps available from EMAUX Pool Systems, forming a total pool filtration system built to last. Take care to match the pump and filter capacities to gain maximum performance and efficiency.

THE SPARKLING CLEAR WATER DIFFERENCE

Cartridge filtration is an effective trouble-free proven method of filtration. Pool water enters the filter and passes through a polyester single element cartridge. Suspended particles are trapped and the water is returned to the pool. As the build-up of dirt in the element increases, so the water pressure rises and the flow decreases. When the pressure reaches an unacceptable level, the element must be removed and cleaned (spray washing with a common garden hose is generally sufficient)

INSTALLATION AND OPERATION INSTRUCTIONS

LOCATION

The filter should be placed in its permanent location, preferably as close to the pool or spa as practicable. Position the filter tank and pump on a level concrete slab or similar base. Allow sufficient space around the filter for routine maintenance and provide for adequate ventilation and drainage.

Place the pump in position on the slab and locate the filter alongside with the appropriate pump inlet connection orientated towards the pump. Refer to the 'Specifications' section for the minimum clearance measurements required for each model.

WEATHER PROTECTION

EMAUX cartridge filters are constructed of corrosion resistant materials. However, to ensure years of reliable performance, it is recommended that the filtration system be adequately protected from the weather.

ASSEMBLY

Assemble the pressure gauge to the filter lid using Teflon tape on the male thread. Do not over tighten.

PIPE CONNECTIONS

Piping should be supported independently and not impose heavy loads on the filter or pump. Use 40mm or 50mm PVC pipe for pump and pool return lines. 50mm should always be used if length of piping is over 15mm. EMAUX cartridge filters are supplied with quick connect couplings suitable for 40mm L.D. PVC pipe or 50mm O.D fittings.

If the pump and filter are located below pool water level, it is necessary to fit isolating valves in the pipe between the pump and the pools, and in the return line from the filter to the pool.

1. Pump to filter

EMAUX cartridge filters are equipped with two inlet ports marked 'INLET'. Select the inlet port most suitable for the installation and plug the other inlet port with blanking cap provided. Using quick connect couplings, connect the pool pump delivery piping to the selected inlet port couplings, connect the pool pump delivery piping to the selected inlet port. Tighten by hand only. Ensure the 'O'ring lubricant and in the correct position.

2. Filter to pool Return

Using quick connect couplings, connect the pool return piping to the filter fitting marked 'OUTLET'. Tighten the fitting by hand only. Ensure the 'O'ring on the fitting is clean, lubricated with 'O'ring lubricant and in the correct position.

The filter base is provided with four mounting holes to enable it to be secured, if required.

FILTER OPERATION

1. Make sure the pump is primed according to manufacturer's directions.
2. Be sure all valves are open on suction and discharge lines. Ensure the air bleed valve on the filter lid is open and the lid lock ring is in place and secure.
3. Start the pump. Close the air bleed valve when water is expelled.
4. To determine the correct operating conditions with a clean filter, check that the pressure gauge reading is 80kpa or below.

5. Record the pressure gauge reading or mark the needle position on the face of the pressure gauge.
6. Operate the filter for a sufficient time to circulate the total pool water volume daily. The filter should also be operated at all times the pool is in use and for about one hour afterwards. During winter, the running time may be reduced. Filter operating requirements will vary for spa applications. Depending upon the system design, type and size of spa. Consult your builder or spa supplier.
7. When the pressure gauge reading is 50-70kpa higher than the 'clean filter' reading as in (4) above, it is time to clean the cartridge element (see' Cartridge Cleaning Procedure)

CARTRIDGE CLEANING PROCEDURE

When the filter gauge reading is 50-70kpa above the clean filter gauge reading cleaning the single element cartridge is required. To perform the cleaning procedures-

1. Switch off the pump.
2. Close isolating valves on suction and discharge lines where fitted.
3. Open the air bleed valve on the filter lid. unscrew the lock ring and remove the filter lid.
4. Lift out the cartridge element.
5. In most cases the element can be easily cleaned with a garden hose, using good velocity sprayed directly on the pleats.

NOTE

Algae, calcium, clay, suntan oil and body oils can form a coating on the element which may not be easily removed with normal hosing. These materials can be removed by soaking the element in a de-greaser and /or descaler. Your local EMAUX dealer will be able to recommend suitable products.

CARTRIDGE RE-ASSEMBLY INSTRUCTION

1. Install the cartridge/s and center pipe so that it is located in the bottom spigot.
2. Ensure the filter lid 'O' ring is clean, lubricated with 'O' ring lubricant and located in the bottom groove.
3. Replace the lid and press firmly in place. Screw down the lock ring, hand tight is sufficient-DO NOT OVERTIGHTEN.
4. Make sure the pump is primed according to manufacturer's directions.
5. Ensure all valves are open on suction and discharge lines.
6. Start the pump.
7. Close the air bleed valve when all air has been expelled.

SPECIFICATIONS

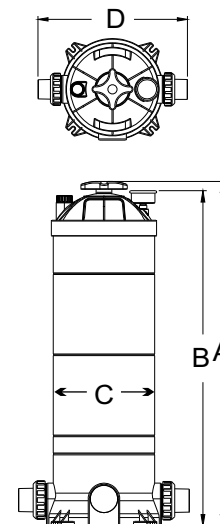

DIMENSION TABLE

Model	High mm A	High mm B	Diameter mm C	Diameter mm D	Filtration Area (m ²)	Design Flow (m ³ /h)
CFO25	411	400	225	397	2.25	5.5
CFO50	591	580	225	397	4.63	11.4
CFO75	771	760	225	397	7.00	17.0
CFO100	951	940	225	397	9.38	22.9
CFO150	1131	1120	225	397	13.71	33.4
CFO200	1311	1300	225	397	16.81	40.9



www.quimiaspool.com

Ingenierie, S.A. de C.V. E-mail: direccion@quimiaspool.com

Tel. 5 537 9147 y 556 413 0072

Gardenias 1, Santa María Palapa, San Martín de las
Pirámides, Edo. Méx. CP. 55851